

V-9 Labeled Wood Veneered Lite Beading*

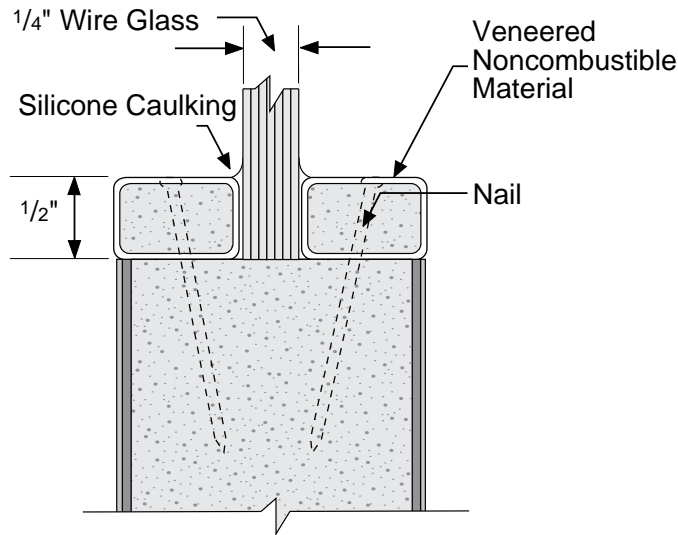

Order by lite opening (cutout) size, the same as other wood beaded lites—not by exposed glass size as when ordering metal vision panels.

Product Features

Use	For use in FD ¾, 1 and 1½ Hour Fire Doors. For larger sizes in FD ¾ Hour, see next page.
Species Available	Cherry, Mahogany, Natural Birch, Red Oak, Walnut and White Oak. Other species available by special order.
Sizes	Various sizes available in full-inch increments up to maximum area/size listed below.
Listed	UL and ITS-WH listed.
Glass Size	Glass should be cut ⅛" less in length and width than lite opening size ordered.
Maximum Cutout	136 sq. inches. Maximums: 13" width, 34" height.
Maximum Visible Glass Size	100 sq. inches
Parts List	1 Instruction Sheet 8 Prefit wood beads with nails pre-fitted into the lite opening. 1 Tube of Silicone caulk or glazing tape. (EPDM or Norton V990) Supplied with glass by glazers. 1 Piece of ¼" fire rated glass per NFPA 80 labeled for Fire Protection Rating. Supplied by glazers. Note: Glass should be cut ⅛" less in length and width than the lite opening size.
Installation Instructions (W-9 recessed bead)	<ol style="list-style-type: none"> 1. Verify that all parts needed for installation are available. 2. Remove one set of wood beads from the door. Position the remaining set of beads flush to the surface of the door and nail in place. 3. Apply a good bead of silicone caulk or glazing tape to the fixed wood bead on the surface where the glass will be placed. Note: It is the responsibility of the glazer to determine how much caulk or glazing tape is required (based on glass thickness) to position the wood beads flush to both sides of the door . 4. Now place the glass against the fixed wood bead that has the silicone caulk or glazing tape applied. 5. Next apply a good bead of silicone caulk or glazing tape to the glass around the perimeter. 6. Nail the loose wood beads in place. 7. Use caution in nailing beads so as to avoid striking bead. 8. Countersink nails and fill holes with matching putty. 9. Finish same as door faces. <i>You may prefer to finish beads before installation.</i>
Note	Must specify glass type if other than ¼" wire glass.

*U.S. Patent No. 4,637,182